

Salem 2026

Redistricting Update





A Growing Salem

- Last redistricting: 2014
 - Six to four in 2012, then to five in 2014
- Voter registration on Jan. 7, 2015: 19,658
- Current voter registration: 21,367 (2/4/25)
- Anticipated growth in the near future:
 - Tuscan Village build out
 - Depot and Main
 - Brady Ave development
 - Others

Fisk	3,609
Soule	4,076
Barron	3,274
Senior Center	5,416
North Salem	5,262
Total	21,367



Review of Existing Facilities

- Five polling locations
 - Staffing is a challenge
- Locations are unevenly distributed
 - Some locations are better equipped than others.
 - Soule School is under severe pressure to take Tuscan Village voters
 - Soule is perhaps least equipped to deal with influx
- In this year's Presidential Primary, the state election observer singled out Soule and Senior Center as lacking capacity.

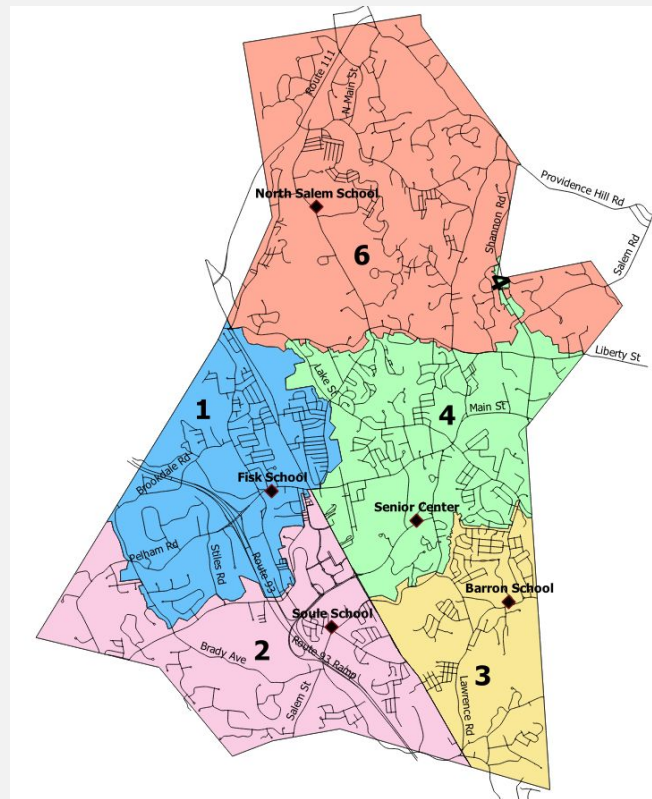



North Salem School



Voters By Checklist	5,262
Onsite Parking	64
Election Employee Parking	0 (Offsite)
Voter Parking (Presidential)	64
Voters Per Parking Space	82

Notable limitations:

- Parking
- Traffic flow

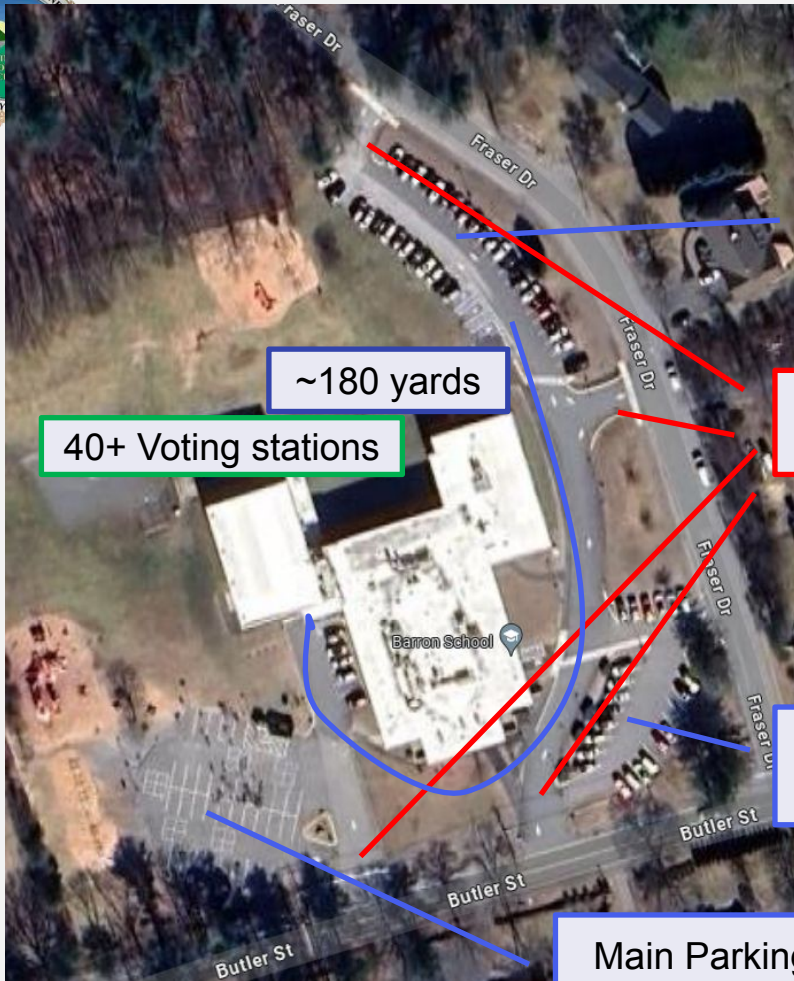

Barron School

Overflow Parking
Area
(40 spaces, 3
HCA)

Four points of
entry/exit

Secondary Parking
(25 spaces, 1
HCA)

Main Parking Area
(41 spaces, 1 HCA)

Voters By Checklist	3,274
Onsite Parking	106
Election Employee Parking	20
Voter Parking (Presidential)	86
Voters Per Parking Space	38

Notable limitations:

- Large parking area more than 150 yards from entrance

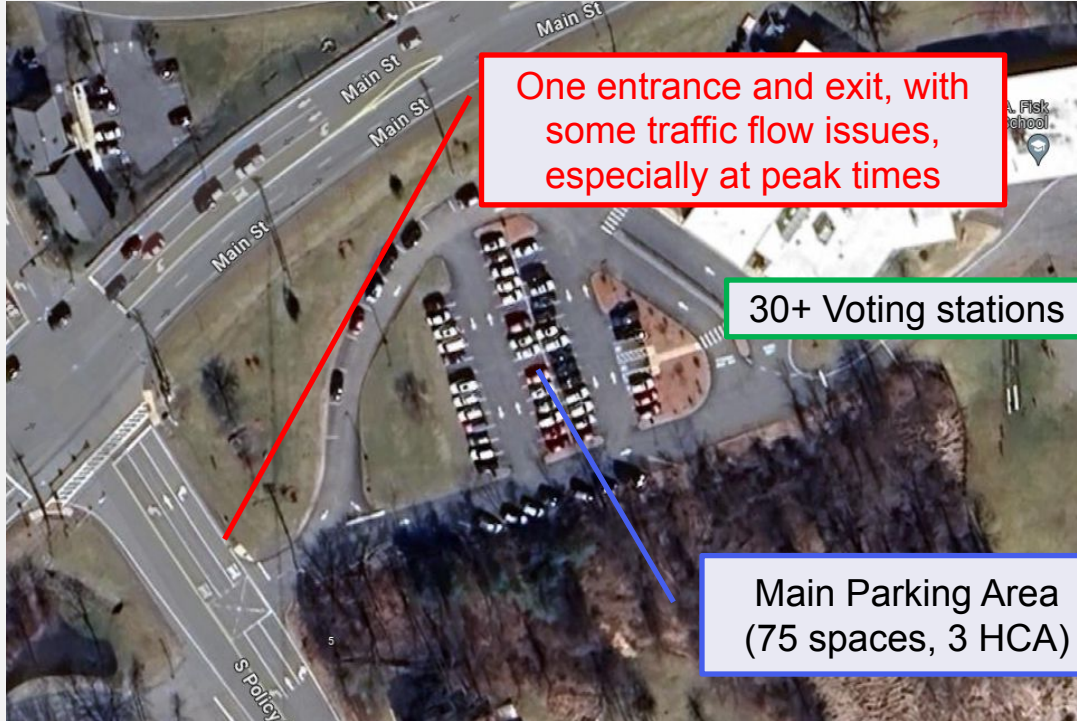

Fisk School

Voters By Checklist	3,609
Onsite Parking	75
Election Employee Parking (in rear)	0
Voter Parking (Presidential)	75
Voters Per Parking Space	48

Notable limitations:

- Traffic flow at certain times of day can be an issue

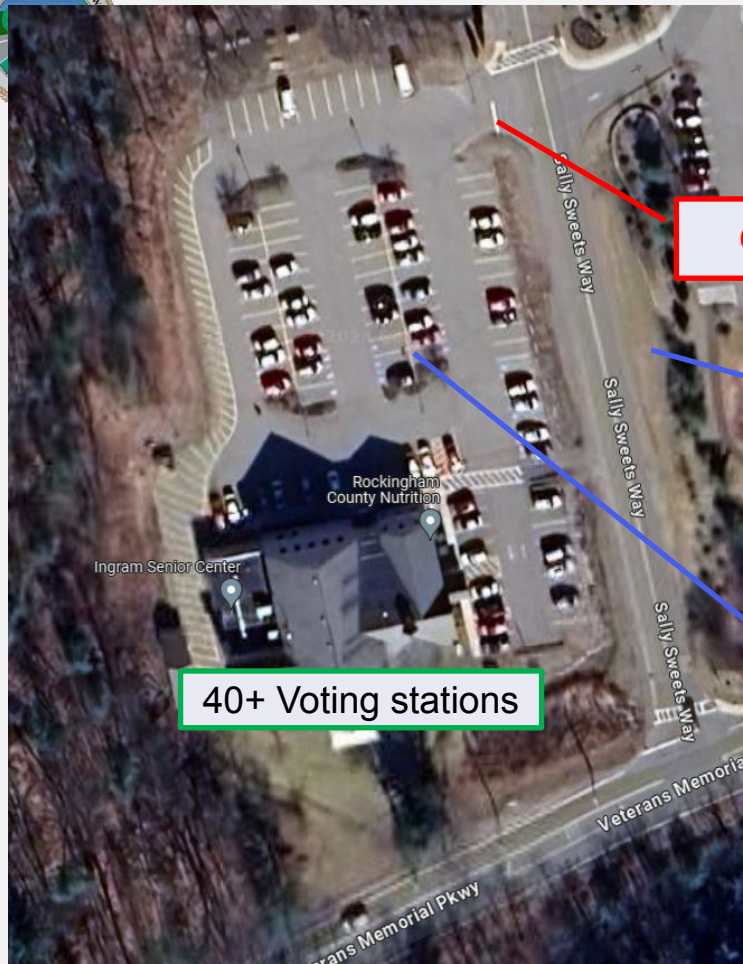

Senior Center

One entrance and exit

Overflow on Sally
Sweets Way
(10 spaces)

Main Parking Area
(114 spaces)

40+ Voting stations

Voters By Checklist	5,416
Onsite Parking	124
Employee Parking	24
Used by Sign holders	10
Voter Parking (Presidential)	90
Voters Per Parking Space	60

Notable limitations:

- Parking
- Traffic flow
- Interior configuration limited



Soule School

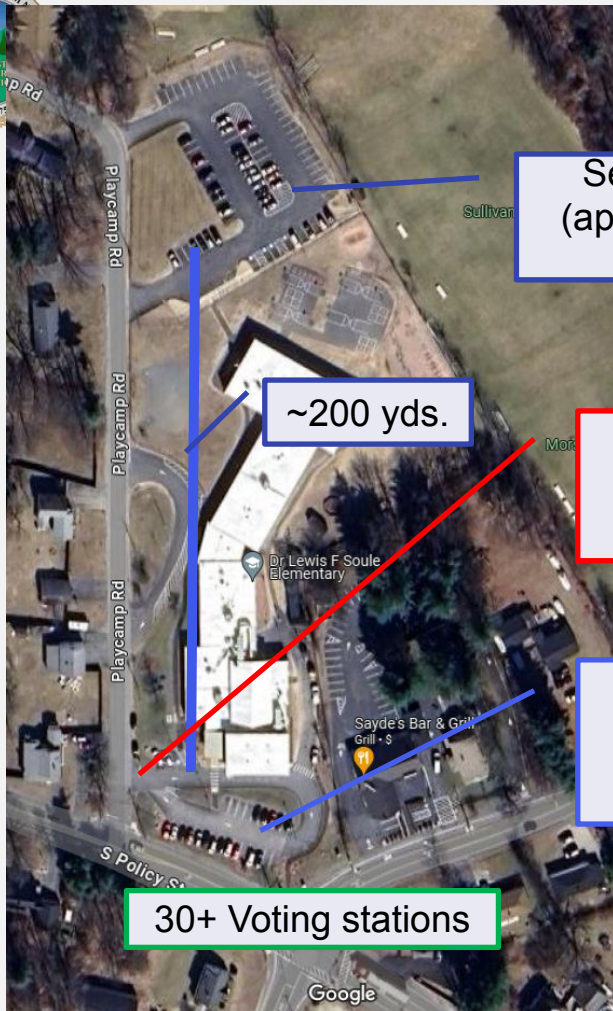

Secondary Parking
(approx. 77 spaces, 4
HCA)

~200 yds.

One entrance and exit, with
severe traffic flow issues

Main Parking Area
(28 spaces, 2 HCA)

30+ Voting stations

Voters By Checklist	4,076
Onsite Parking	105
Employee Parking	20
Voter Parking (Presidential)	85
Voters Per Parking Space	48

Notable limitations:

- Parking: main parking extremely small, 200+ yards to majority of parking area
- Traffic flow



Additional Challenges

- Soule has seen the largest increase in turnout over the last three presidential elections compared to the other polling locations: (775 voters)
- It saw the longest wait times of any polling location during the November election (40+ minutes consistently all day)



Turnout Over Time

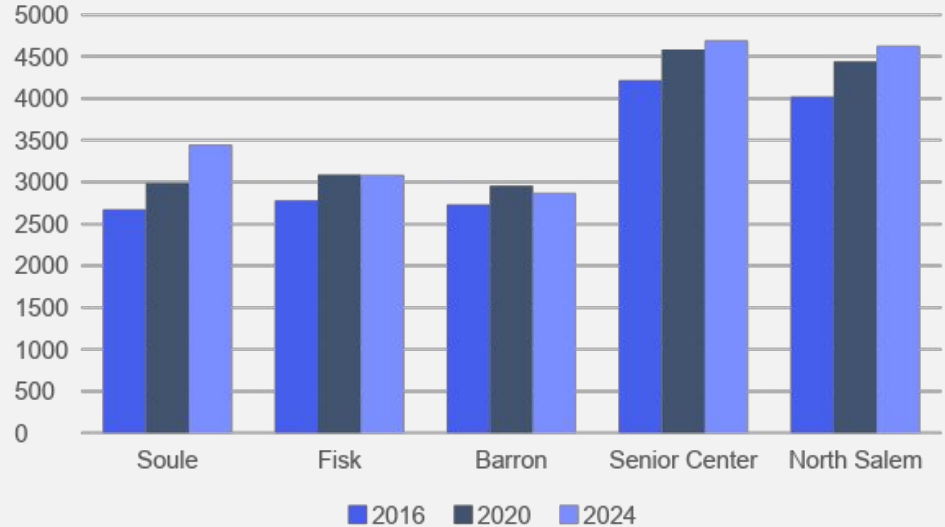



Proposed Changes

- Relocate current District 4 polling location from Senior Center to Woodbury School
- Eliminate Soule School as a polling location
- Renumber the Districts to eliminate skips and reduce confusion
- Woodbury provides better location from a parking and traffic flow standpoint
- Reducing the number of locations alleviates staffing issues
- Better positions the town to handle future growth in voting population



Proposed Map

- These numbers have been created from the most recent checklist update.

North Salem	5,245
Woodbury	8,542
Fisk	3,527
Barron	4,323

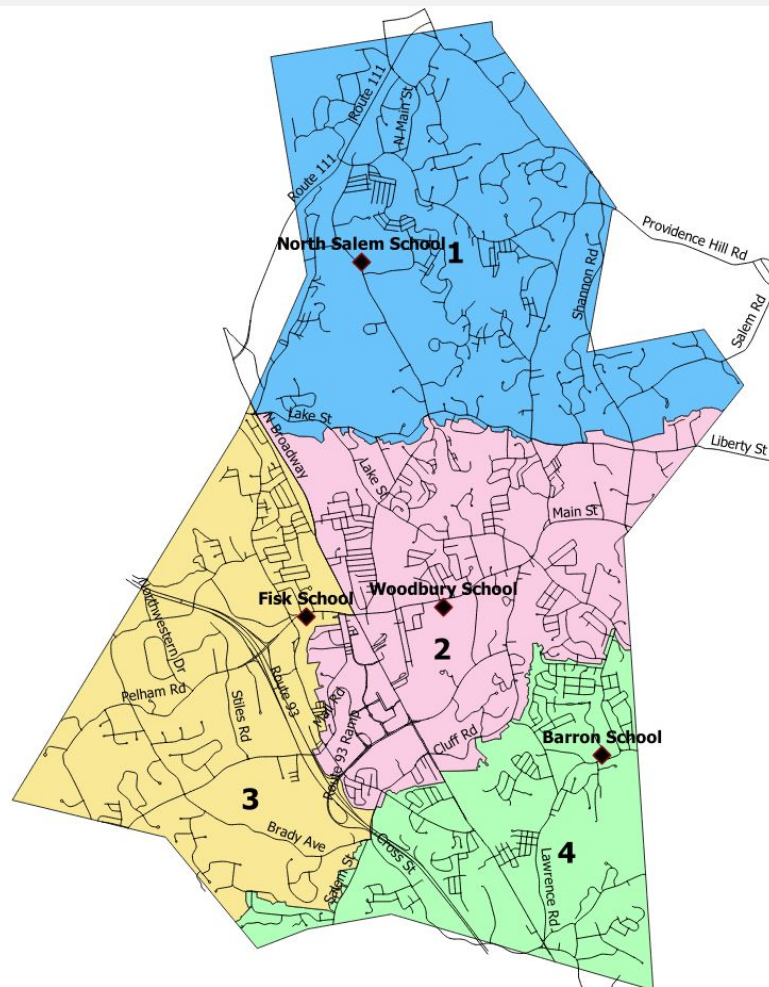

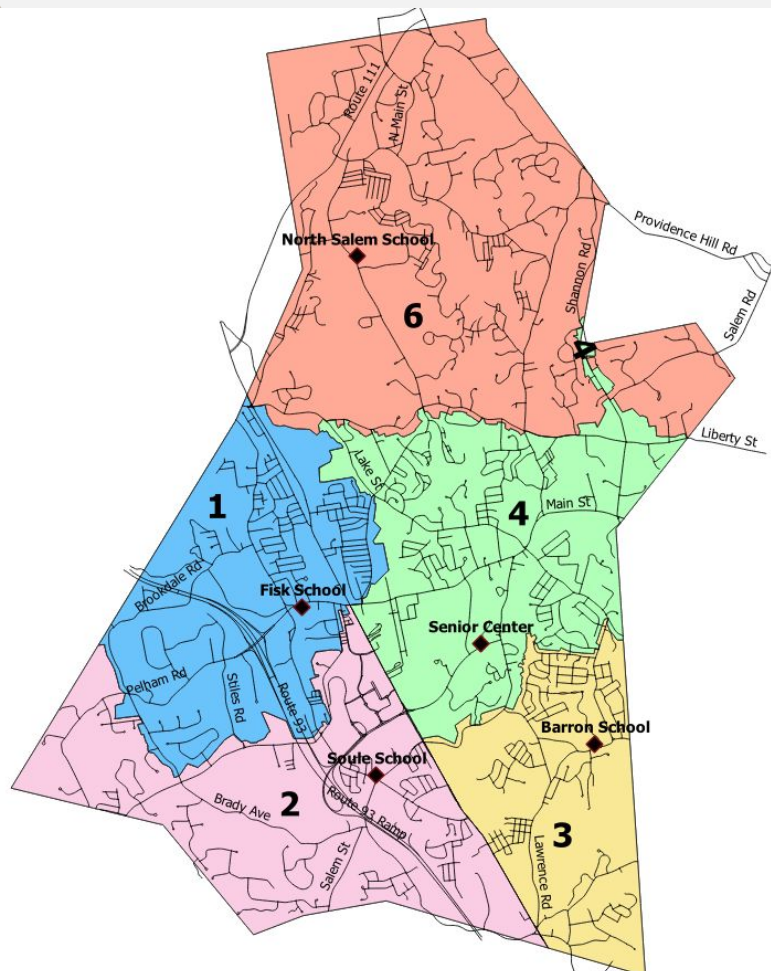

Existing Districts and Polling Locations

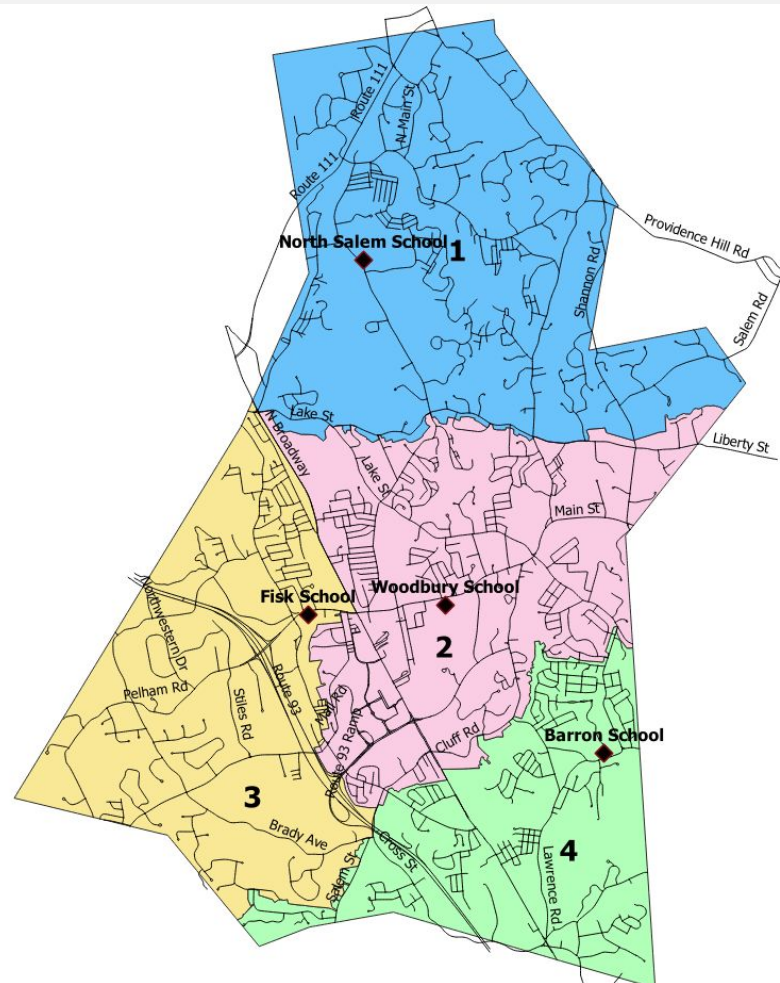

Proposed Districts and Polling Locations



	North Salem	Barron	Fisk	Sen. Center/ Woodbury	Soule
Current	5,416	3,274	3,609	5,416	4,076
Proposed	5,245	4,323	3,527	8,542	0
Difference	-171	+1,049	-82	+3,126	-4,076



North Salem School



Voters By Checklist	5,245
Onsite Parking	64
Employee Parking	0
Voter Parking (Presidential)	64
Voters Per Parking Space	82

Notable limitations:

- Parking
- Traffic flow

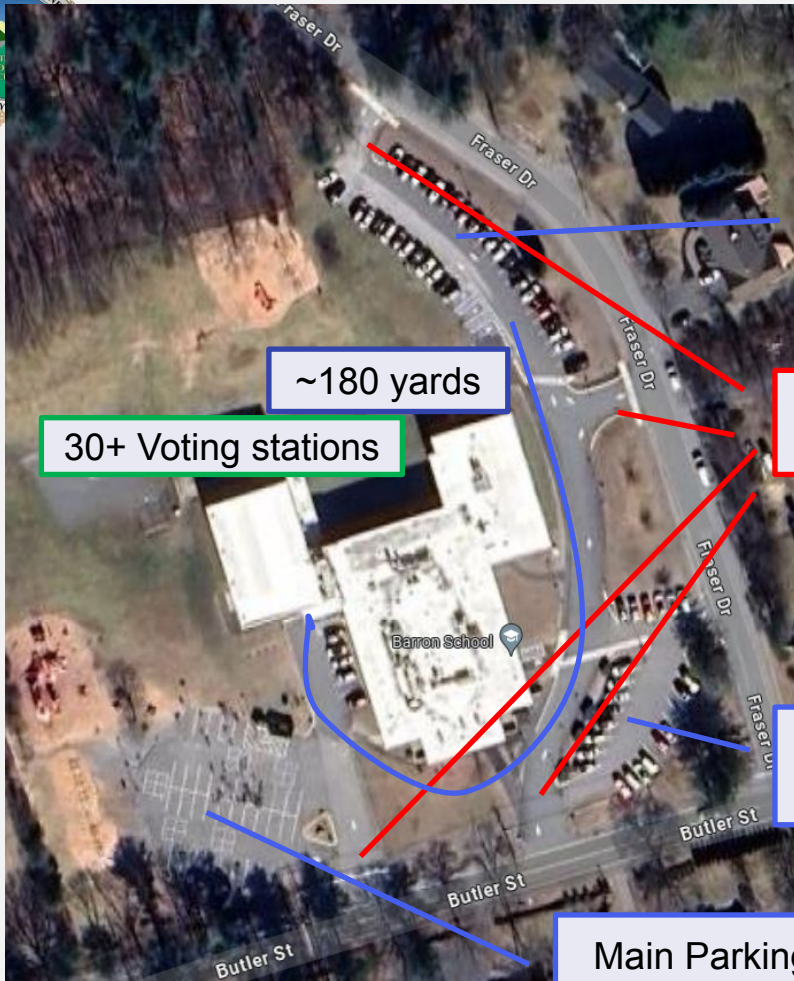

Barron School

Overflow Parking
Area
(40 spaces, 3
HCA)

Four points of
entry/exit

Secondary Parking
(25 spaces, 1
HCA)

Main Parking Area
(41 spaces, 1 HCA)

Voters By Checklist	4,323
Onsite Parking	106
Employee Parking	20
Voter Parking (Presidential)	86
Voters Per Parking Space	50

Notable limitations:

- Large parking area more than 150 yards from entrance

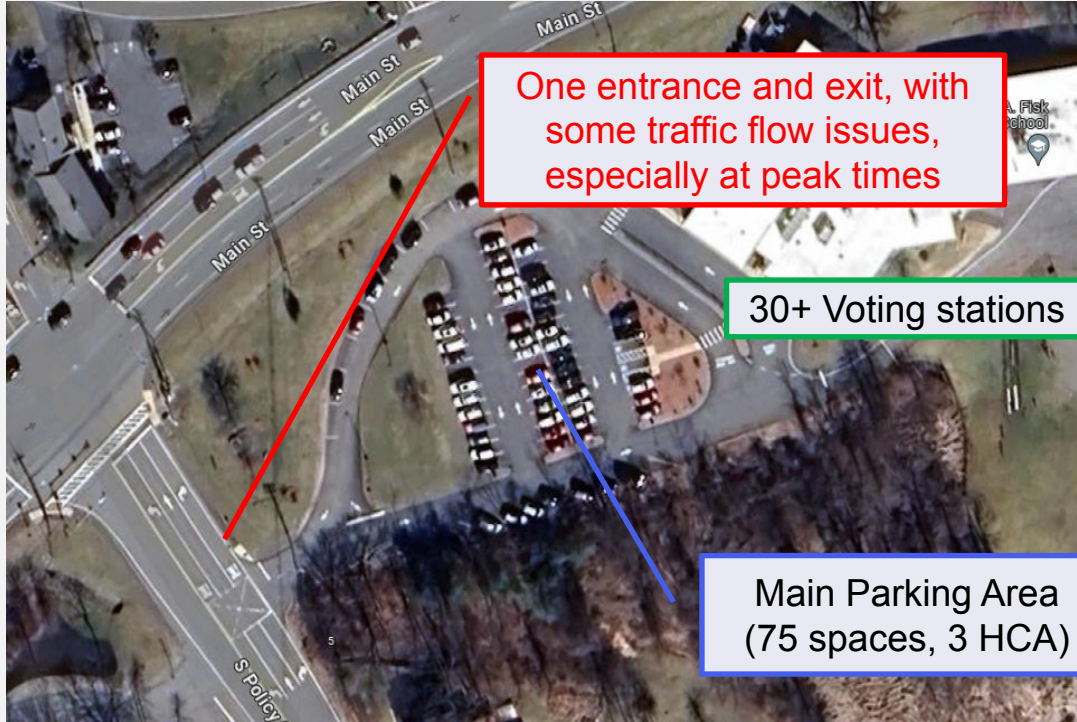

Fisk School

Voters By Checklist	3,527
Onsite Parking	75
Employee Parking	20
Voter Parking (Presidential)	55
Voters Per Parking Space	64

Notable limitations:

- Traffic flow at certain times of day can be an issue



Woodbury School

Voters By Checklist	8,542
Onsite Parking	282
Employee Parking	34
Voter Parking (Presidential)	248
Voters Per Parking Space	34



Exterior Entrance to Woodbury gym

View from entrance to parking: flat and close by:





Woodbury gym interior

View of interior of entrance door





Restrooms directly off the gym, valuable when school is in session. (Not so at SHS)



Doors to Woodbury interior. Can be secured while school is in session.

Lobby area: Supervisors of the Checklist could use this area for Presidential Elections when school is closed



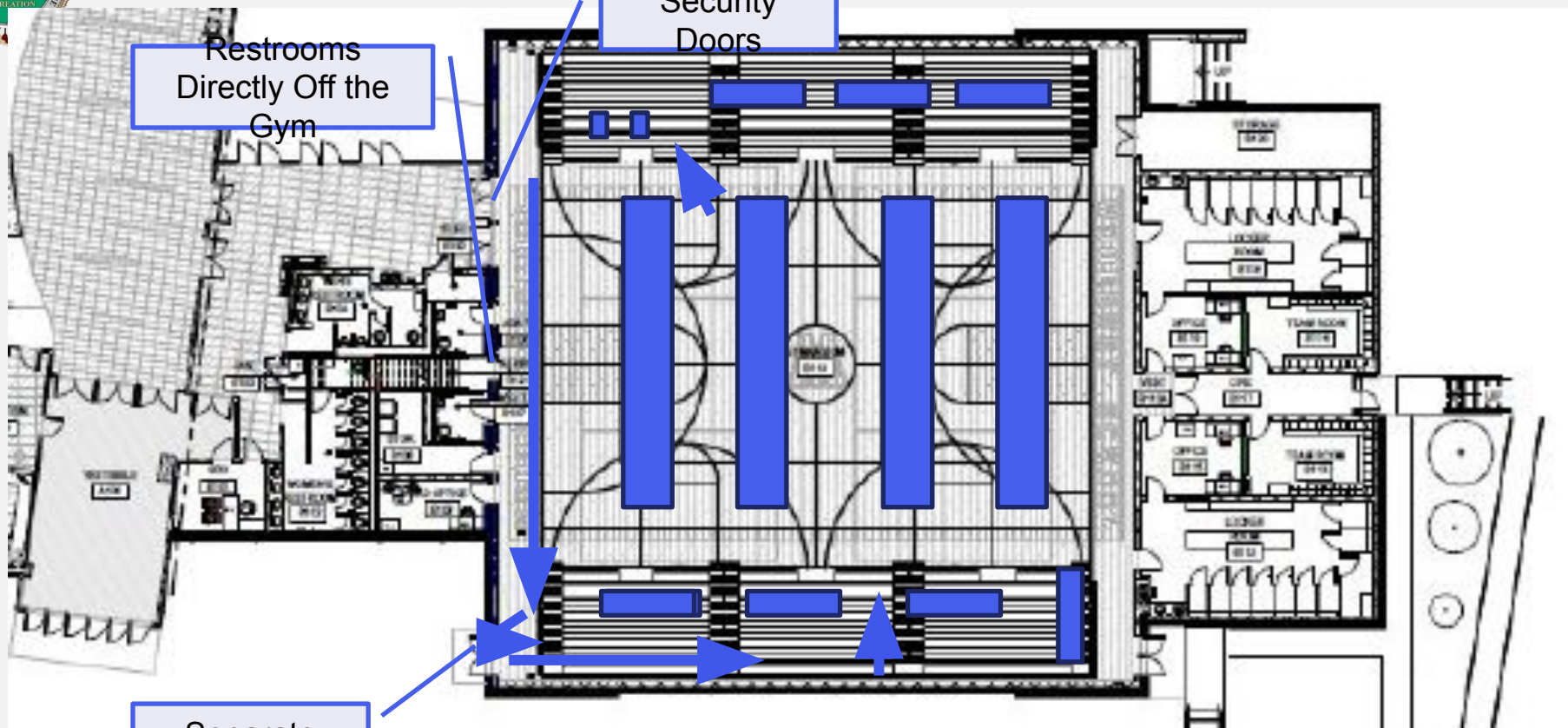

Restrooms
Directly Off the
Gym

Internal
Security
Doors

Separate
Entrance



Why not Salem High School?

- While Salem High School seems like an attractive alternative, it has several drawbacks:
 - **Parking:** While there is ample parking, it is not situated in ways to give proper access to locations where voting would be taking place. Most handicapped accessible parking is located at the *front* of the building, near Geremonty Drive, rather than near the two gymnasiums. The closest accessible parking to the Davis Gymnasium is over 100 yards away, uphill.
 - The Davis Gymnasium is not appreciably larger than the new gym at Woodbury, and parking much closer and the terrain level.
 - The Lower Gym at SHS, which could theoretically support enough polling stations to accommodate the whole community, is not designed for direct public access, and parking would be an issue.
 - Given there is no appreciable difference between capacity at Woodbury vs. SHS, Woodbury makes a better choice due to accessibility issues.
 - Both gym locations at SHS would be difficult to isolate from the school for elections held while school is in session.
 - And reducing to one polling location for the whole town creates logistical issues of its own. SHS would not be able to accommodate students on election day due to student parking requirements, even for a municipal election. Closing SHS would necessitate closing all schools due to contract equity. Spreading out the load enables school to remain in session for municipal elections and state primaries.



Student Parking
Area
(268 spaces)

PAC Parking
(10 HC, 19 standard)

Front Visitor Lot
(~80 spaces)

80+ Voting stations
at in the Davis
Gym

200+ Voting
stations in lower
gym

Staff Parking Area
(~150 spaces)

Limited public
access, and
parking to this
location

~100 yards



View from PAC Entrance to main parking

View from PAC Entrance to Davis Gym





View down stairs to Lower Gym from main PAC level
(Elevator not pictured)



Lower Gym capacity and view





Lower Gym outside entrance
(across from Grant Field entrance)

View toward rear parking





View of Lower Gym entrance
towards to main parking



Restrooms are
not self
contained.

Can only be
accessed
through school
building

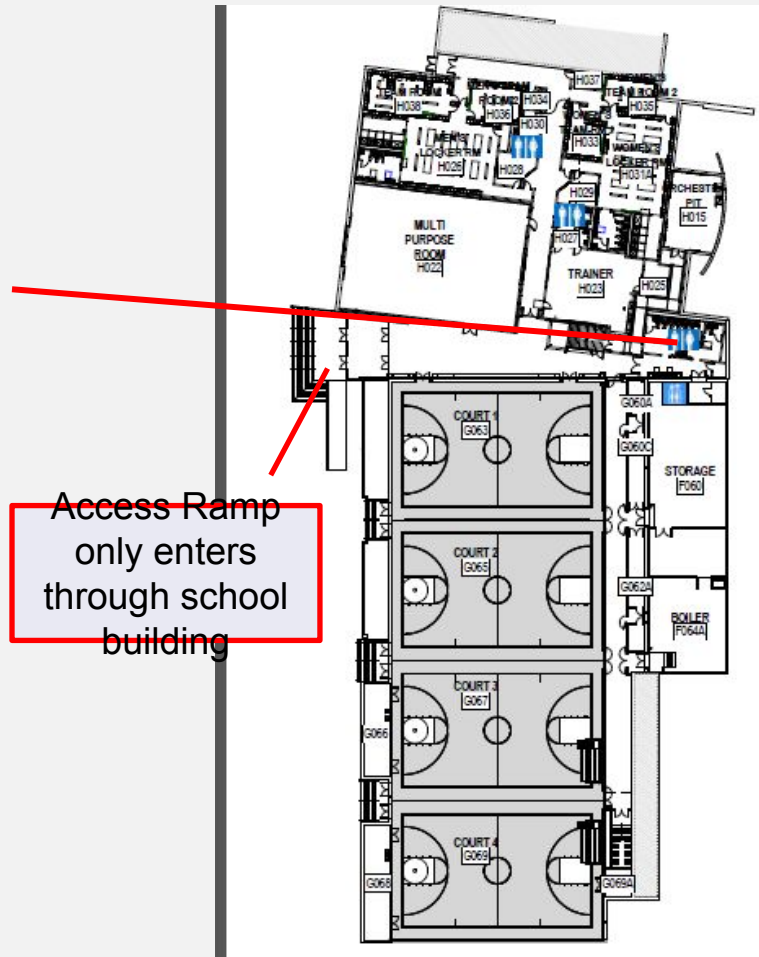

Access Ramp
only enters
through school
building

Timeline

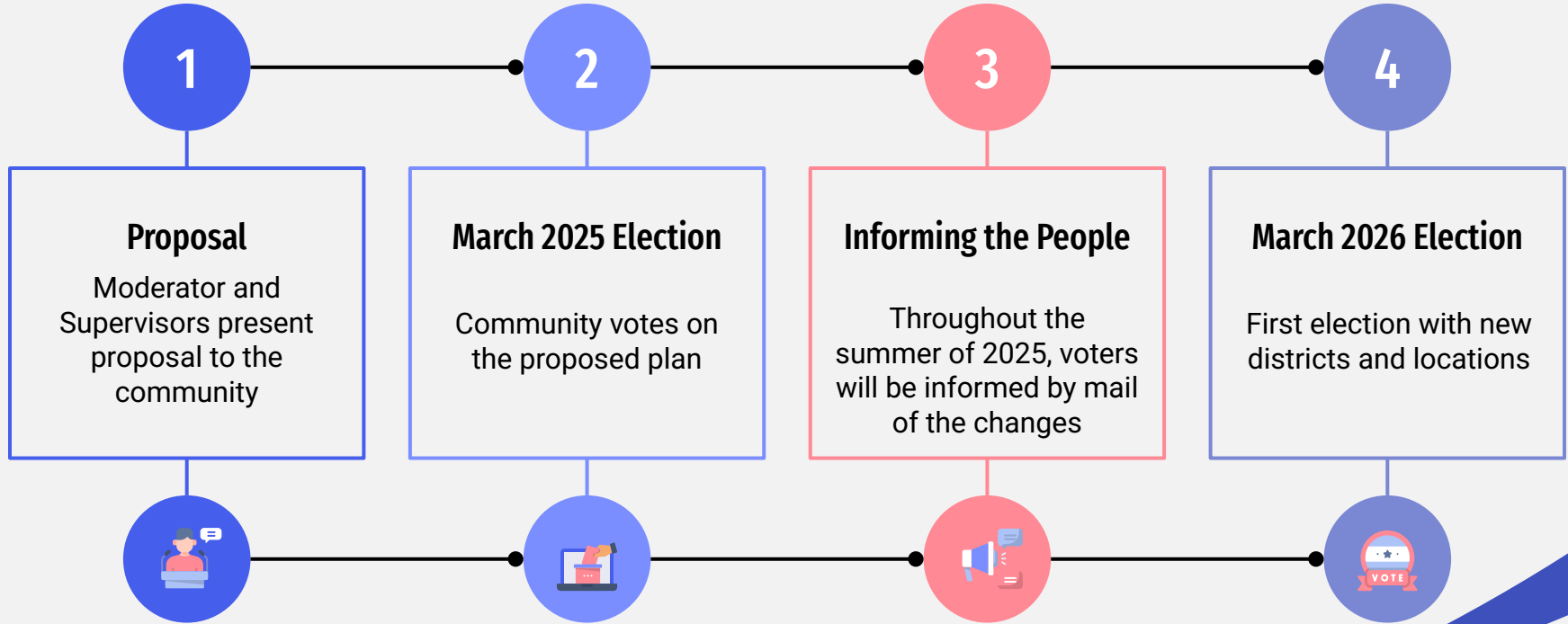

Thank You

Graphics Courtesy
Slidesgo and **Freepik**

